

The AMP MOD is a stereo guitar amp that mounts in the Modular Endpanel of your Templeboard. Each channel provides 50W of power for a total of 100W. When using one channel in mono mode, the AMP MOD pushes approximately 75W.

The Amp Mod utilizes DSP to simulate the tone of a traditional tube amp (Fender Twin). You can disable amp modeling using the DIP switches if using an external amp modeler, bass guitar, or in any scenario where you don't want the character of the amp simulation. See DIP switch section for more info.

INSTALLATION

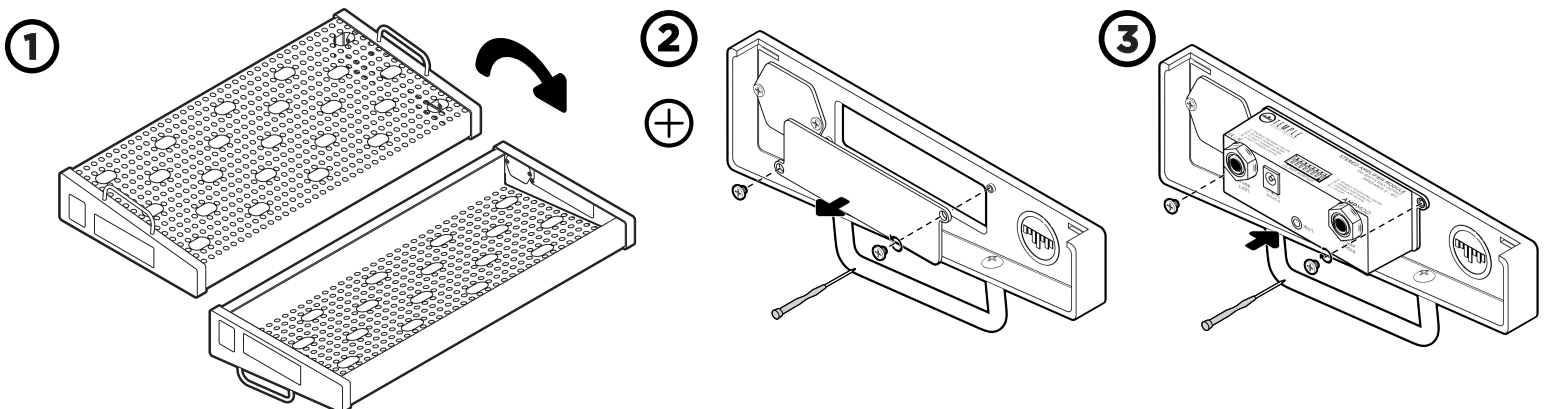

FRONT

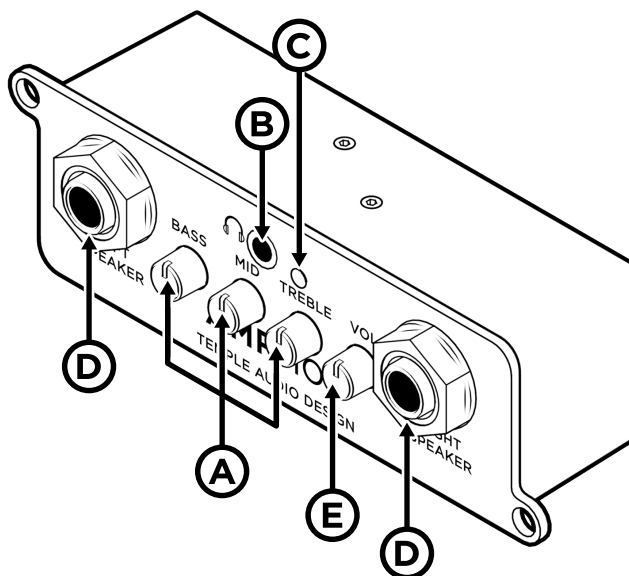

A - THREE BAND EQUALIZER

Use the knobs in the EQ section to boost and cut the desired frequency range. The bass, mid, and treble knobs at “12 o’clock” (straight up) will yield the most neutral response. Turning an EQ knob clockwise will increase the level of the selected frequency. Turning a knob counter-clockwise will decrease the level of the selected frequency.

B - HEADPHONE AMP

The AMP MOD includes a clean and powerful headphone amplifier. Plug wired headphones into the front 1/8” headphone port. Control the headphone volume and tone using the knobs on the front of the AMP MOD. The impulse response cabinet simulation and DSP amp modeling work to help your guitar playing react in a familiar way.

C - LED INDICATOR

White: Normal operation. MOD is properly powered and functioning.

Yellow: Input level overloading the DSP input. Reduce input level.

Red: Fault or overheat. Faults indicate short circuit in speaker cable.

D - SPEAKER OUTPUTS

Connect 1/4” speaker cables from one or both of these outputs to your speaker cabinets.

E - VOLUME CONTROL

Controls the output volume for both the 1/4” outputs and the headphone amp.

BACK

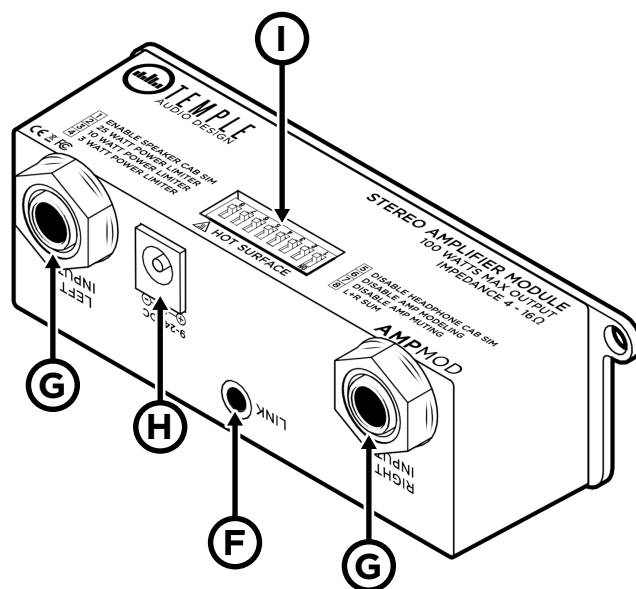

F - LINK JACK

This is a buffered stereo output that allows you to connect the AMP MOD to other Temple Audio output MODs (eg. 4X MOD, SUM MOD, DI MOD Pro, etc). Use an 1/8" TRS to dual 1/4" TS cable (sold separately) to send the stereo output signal to other MODs.

G - STEREO INPUTS

Plug 1/4" cables into these inputs. Plugging into the left input only will split a mono signal to both outputs. (1MΩ input impedance)

H - POWER REQUIREMENTS

The AMP MOD can function at different wattages depending on the power supply you are using. It is compatible with virtually any power supply.

	3W	10W	25W	100W
9V	300mA	1.1A	-	-
12V	250mA	830mA	2.1A	-
18V	170mA	550mA	1.4A	-
24V	125mA	420mA	1A	4.6A

The Power Jack accepts center-pin-negative OR center-pin-positive connections. This enables use with a wide variety of power supplies.

Providing less power than necessary for the selected wattage may result in the power supply shutting down at increased volumes. Always ensure you match the DIP switch setting to the amount of power you are providing the AMP MOD (see DIP SWITCHES section).

I - DIP SWITCHES

These switches allow you to alter specific functions on the AMP MOD. See DIP SWITCHES section for more information.

DIP SWITCHES

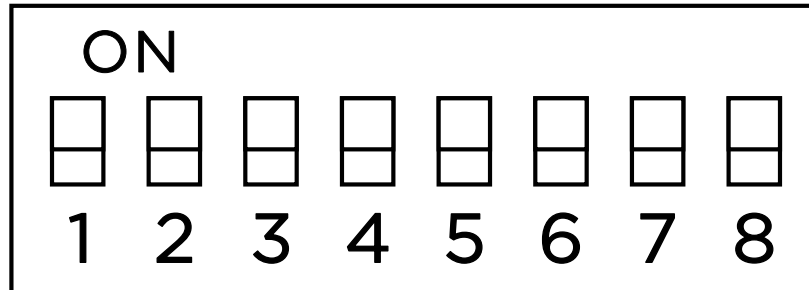

1 ENABLE SPEAKER CAB SIM

Enables the impulse response speaker cabinet simulation through the power amp outputs. Useful for playing guitar through full-range speakers.

2 25 WATT POWER LIMITER

Approx 24V, 1A recommended

Power Supply Examples: Link output from Strymon power supplies or Cioks Hi5/DC7.

3 10 WATT POWER LIMITER

Approx 12V, 1A or two 9v, 500mA (in parallel) recommended

Power Supply Examples: X-Link output from Pedal Power 3/3+, or any option from the 3 Watt list (using two channels with a current doubling cable).

3 3 WATT POWER LIMITER

Approx 9v, 500mA recommended

Power Supply Examples: Cioks Hi5/DC7, Voodoo Labs Pedal Power 3/3+, Strymon Zuma/Flint, TrueTone CS/1 Spot, Fender Engine Room, etc.

5 DISABLE HEADPHONE CAB SIM

Bypasses the impulse response speaker cabinet simulation on the headphone output. Useful when combined with an external impulse response device like the Line 6 Helix, Strymon Iridium, etc.

6 DISABLE AMP MODELING

Bypasses the DSP amp modeling in the headphone and speaker output. Useful when combined with an external amp modeler (Helix, Iridium, etc.).

7 DISABLE AMP MUTING

Normally, when headphones are plugged in, the power amp is muted. This enables both simultaneously.

8 LEFT + RIGHT SUM

Sums the left and right inputs. Useful for a mono setup of a stereo pedalboard.

CONFIGURATION OPTIONS

**Mono IN
Stereo OUT**

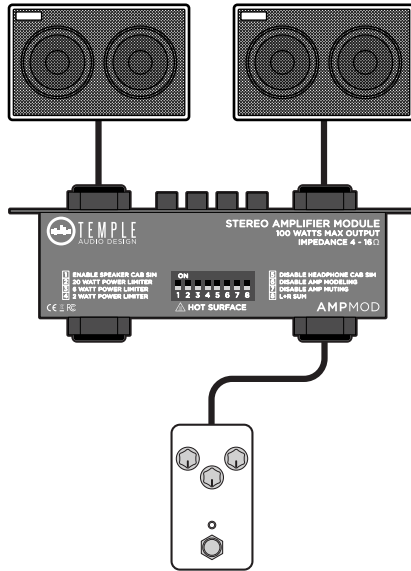

**Stereo IN
Mono OUT**

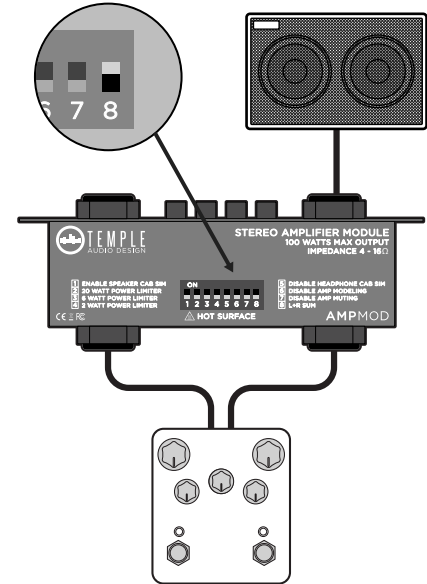

**Mono IN
Mono OUT**

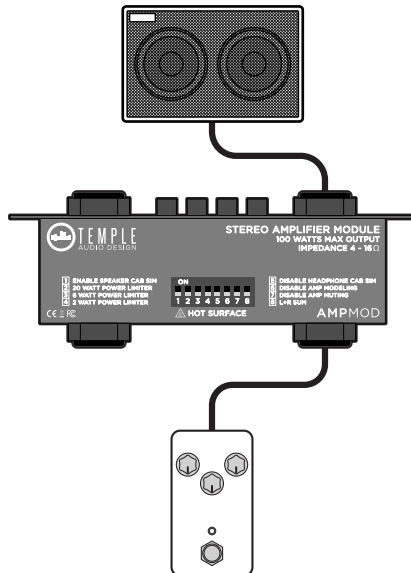

**Stereo IN
Stereo OUT**

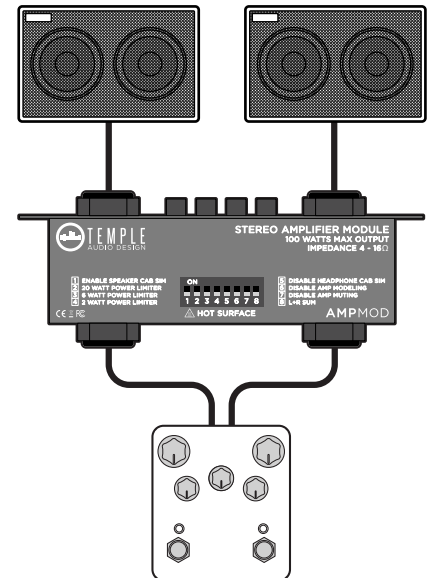

SPECIFICATIONS

Input Impedance: 1MΩ

Link Output Impedance: ~50Ω

Headphone power: 250mW per channel into 16Ω load