

The IEC MOD is a an end cap mounted IEC power inlet with integrated on/off switch. It is designed to be installed in the side of your Templeboard, providing a power connection for an under-mounted power supply.

## INSTALLATION

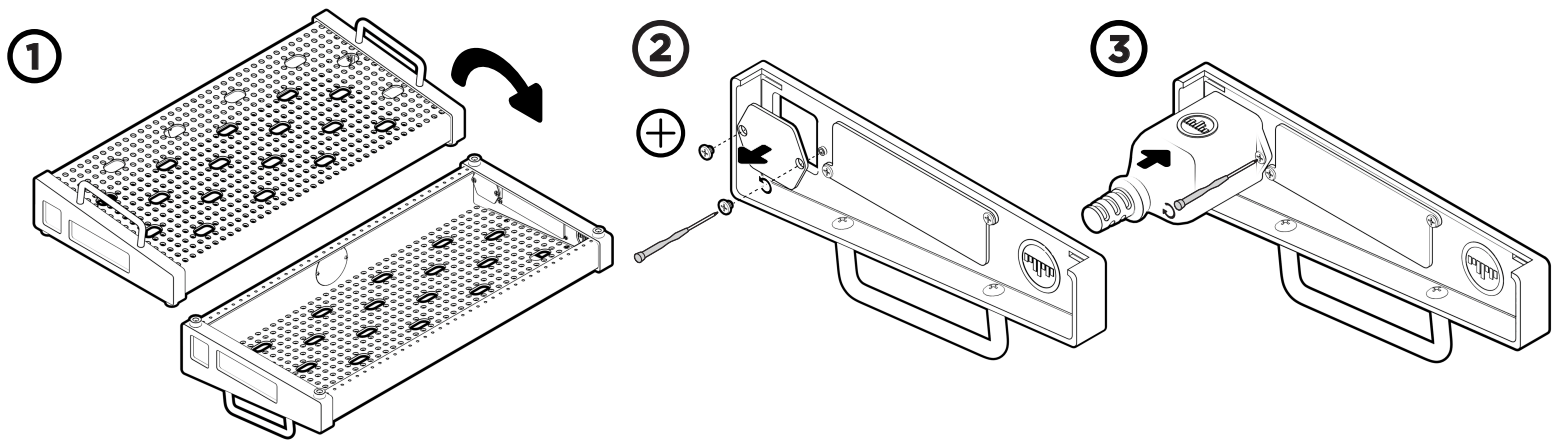

1. Prepare: Remove feet and handle screws from the end cap where you'll install the IEC MOD.
2. Remove End Cap: Gently tap with a rubber mallet if needed.
3. Remove Blank: Take out the two black screws and powder coated aluminum blank from the Micro MOD slot.
4. Insert IEC MOD: Place the IEC MOD into the slot with the logo facing the bottom of the board. Align the MOD's eyelets with the end cap's pegs.
5. Secure: Fasten MOD into place with the included silver screws and MOD Driver.

**NOTE:** While it is possible to install the IEC MOD without removing the end caps, we recommend removing the end cap of easier access. SEE THIS VIDEO:  
<https://www.youtube.com/shorts/-VXVKhubC6A>

## TEMPLE POWER SERIES

This system is designed to be the cleanest, most modular and unobtrusive system to power your pedals. It has three parts:

1. IEC Mod or PowerCon Mod: Brings power from the wall to the side of your pedalboard
2. 65 Watt Power Supply: Converts your 120/240V wall power to the required 24V to your Hi5(s)
3. One or more Hi5 MODs

